

PLANTING SPECIFICATIONS

- Deciduous Trees**
A minimum caliper of at least two and one-half (2 1/2") inches measured twelve (12") inches above ground level at time of planting.
- Evergreen Trees**
A minimum of six (6') feet high and a minimum spread of three (3') feet at time of planting.
- Shrubs**
Shrubs shall be at least 12" in diameter at the time of planting.
- Ground Cover and Grass**
Ground cover shall be planted in such a manner so as to present a finished appearance and seventy-five percent (75%) coverage after one complete growing season. If approved as part of a Site Plan, ground cover may also consist of rocks, pebbles, shredded bark, and mulch. Grass shall be planted in species normally grown as permanent lawns.

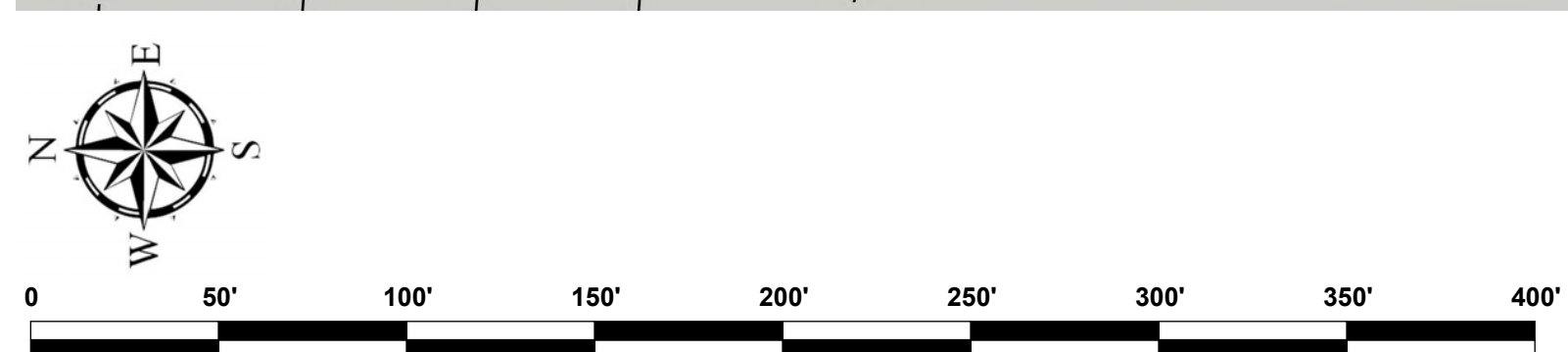
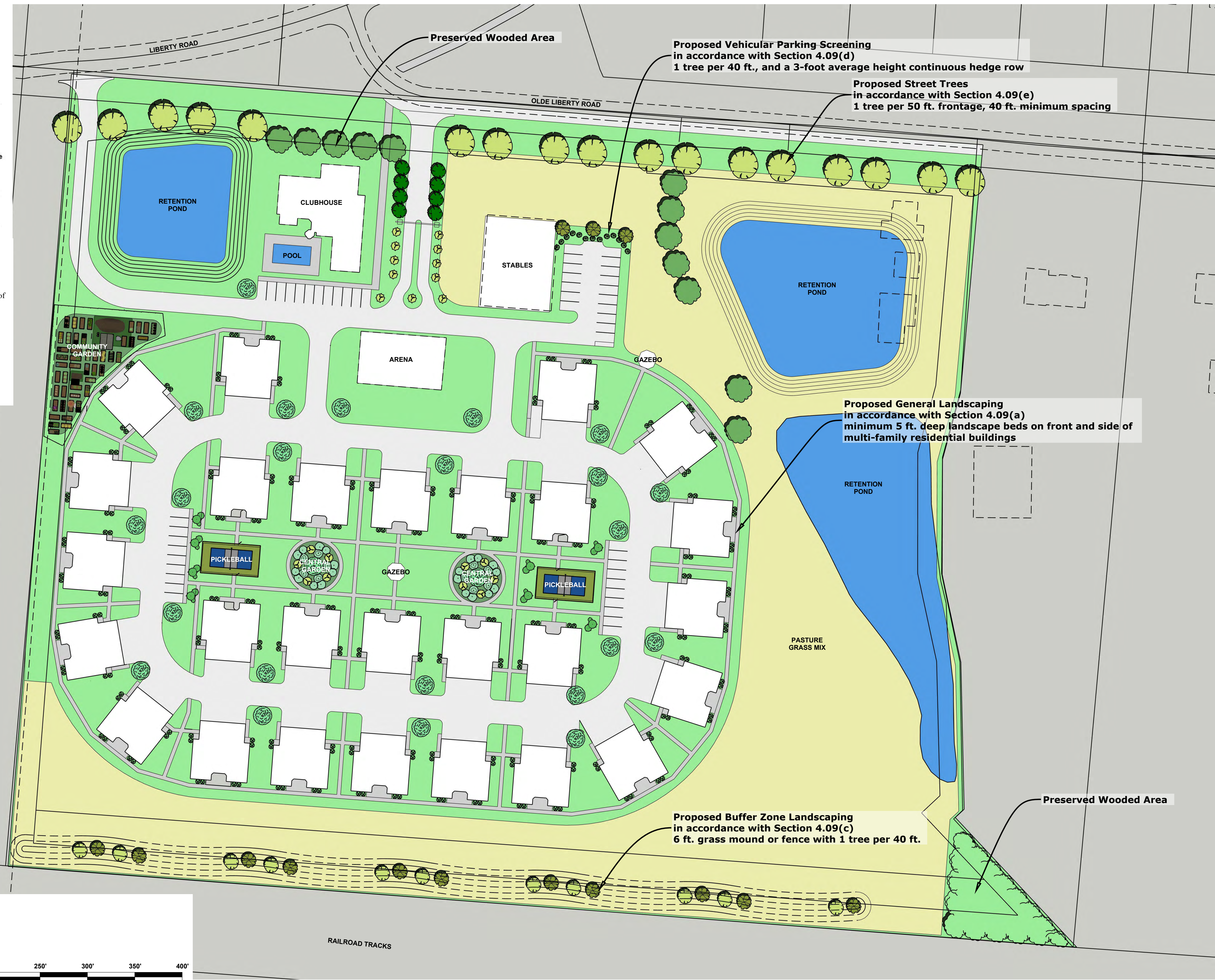

PLANS PREPARED FOR:

PLANS PREPARED BY:
Plan 4 Land
PLAN 4 LAND, LLC
JOE CLASE, AICP
1 SOUTH HARRISON STREET
P.O. BOX 306
ASHLEY, OHIO 43003
(740) 413-4084
WWW.PLAN4LAND.NET

PRELIMINARY LANDSCAPING PLAN

THE EQUESTRIAN

7012 OLD LIBERTY ROAD, POWELL OH 43065

REVISIONS	DATE	DESCRIPTION
NO.	DATE	DESCRIPTION
1	11/18/2025	ADJUSTED DESIGN TO REDUCE 8 UNITS.

DATE:
11/18/2025

JOB NO.: 2025-49

DESIGN: JWC

CHECKED: NBH

SHEET NO.

L01