

Sketch Plan Application

Delaware County, Ohio

(for unincorporated areas only)

RPC Sketch Plan Number

25-03-S
(RPC Staff will assign)

PROJECT	Lane Road	(circle one) Residential Commercial
TOWNSHIP	Porter	

APPLICANT/ CONTACT	Name Plan4Land LLC	Phone 740-413-4084
	Address 1 South Harrison Street, P.O Box 306	E-mail Joe@plan4land.net
	City, State, Zip Ashley, Ohio 43003	

PROPERTY OWNER	Name GRIFFIN HARTSOOK	Phone 567-231-6269
	Address 7735 Lane Road	E-mail ej@tocoio.com
	City, State, Zip Centerburg, Ohio 43011	

SURVEYOR/ ENGINEER	Name Pro Boundary Land Surveyors	Phone 1-614-899-2209
	Address 8850 Commerce Loop Drive	E-mail tim@proboundary.com
	City, State, Zip Columbus, Ohio 43240	

LOCATION	Property Address 7735 Lane Road, Centerburg, Ohio 43011	
	(circle one) N S E W side of Lane Road	Road/Street
	approx. 1,815 feet N S E W of Olive Green Road	Road/Street

DETAILS	Number of Lots 4	Septic Systems yes no
	Total Acreage 9.292 acres	Central Sanitary System yes no

SUBMISSION REQUIREMENTS (Sub. Regs. Section 204.02)	<input checked="" type="checkbox"/>	One (1) copy of Sketch Plan (max. 11" x 17") including:
	<input checked="" type="checkbox"/>	Approximate lot dimensions and acreage;
	<input checked="" type="checkbox"/>	Information to locate site (complete section above: LOCATION);
	<input checked="" type="checkbox"/>	North Arrow (scale preferred also);
	<input checked="" type="checkbox"/>	Indicate woods, watercourses, natural features, easements, buildings, cemeteries, proposed streets, Common Access Drives, and other relevant information;
	<input type="checkbox"/>	Location of labeled stakes and colored flags (optional – NOT REQUIRED);
	<input checked="" type="checkbox"/>	Completed and Signed Application;
	<input checked="" type="checkbox"/>	Fee (Refer to Fee Schedule) \$ 700

Lexus Thornton

02/28/2028

Owner (or agent for owner) and Date

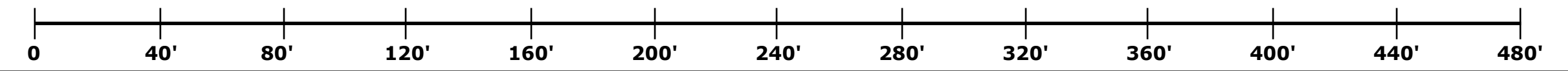



Lane Road CAD
SITE ASSESSMENT

SITE INFORMATION
 7735 Lane Road, Centerburg, Ohio 43011
 Parcel No. 516-100-01-164-001 | +/- 9.292 acres
 Porter Township, Delaware County, State of Ohio
PRINTED
 February 24, 2025

PROJECT NAME
 Lane Road CAD
CLIENT
 EJ O'Leary
 7735 Lane Road
 Centerburg, OH 43011

PREPARED BY
Plan 4 Land
 Plan 4 Land, LLC, Joe Glass, AICP, Principal
 1 St. Harrison St., P.O. Box 306, Ashley, OH 43003
 (740) 418-4084 | joe@plan4land.net | www.plan4land.net

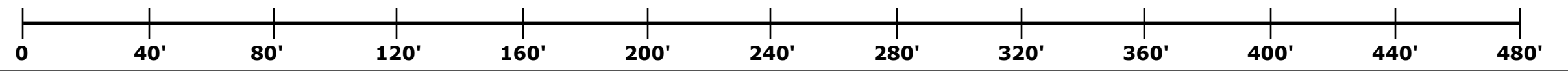

Lane Road CAD
SETBACK EXHIBIT

SITE INFORMATION
 7735 Lane Road, Centerburg, Ohio 43011
 Parcel No. 516-100-01-164-001 | +/- 9.292 acres
 Porter Township, Delaware County, State of Ohio
PRINTED
 February 24, 2025

PROJECT NAME
 Lane Road CAD
CLIENT
 EJ O'Leary
 7735 Lane Road
 Centerburg, OH 43011

PREPARED BY
Plan 4 Land
 Plan 4 Land, LLC, Joe Glass, AICP, Principal
 1 St. Harrison St., P.O. Box 306, Ashley, OH 43003
 (740) 413-4084 | joe@plan4land.net | www.plan4land.net



25-0016
Plan 4 Land
 Plan 4 Land, LLC, Joe Glass, AICP, Principal
 1 St. Harrison St., P.O. Box 306, Ashley, OH 43003
 (740) 413-4084 | joe@plan4land.net | www.plan4land.net

PROJECT NAME
 Lane Road CAD
CLIENT
 EJ O'Leary
 7735 Lane Road
 Centerburg, OH 43011

SITE INFORMATION
 7735 Lane Road, Centerburg, Ohio 43011
 Parcel No. 516-100-01-164-001 | +/- 9.292 acres
 Porter Township, Delaware County, State of Ohio
PRINTED
 February 24, 2025

Lane Road CAD
SITE PLAN



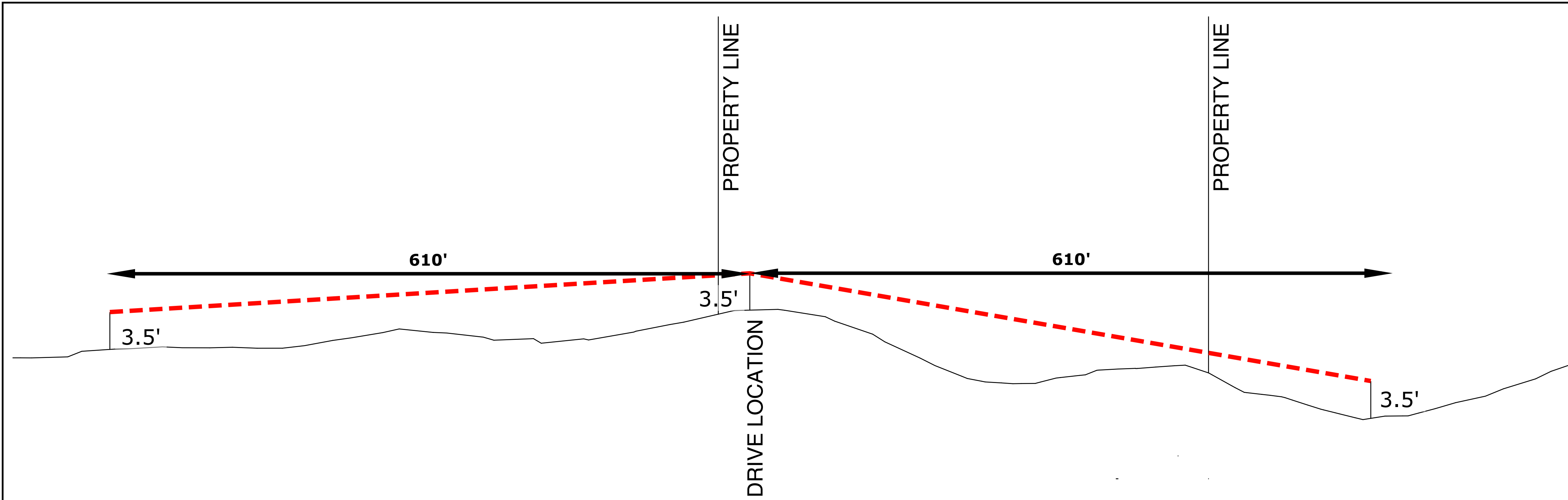

DRIVE PROFILE

HORIZONTAL SCALE 1" = 60'
VERTICLE SCALE 1" = 6'



LINE OF SIGHT

HORIZONTAL SCALE 1" = 60'
VERTICLE SCALE 1" = 6'

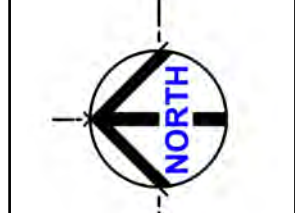
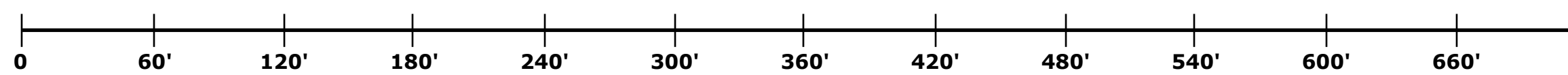

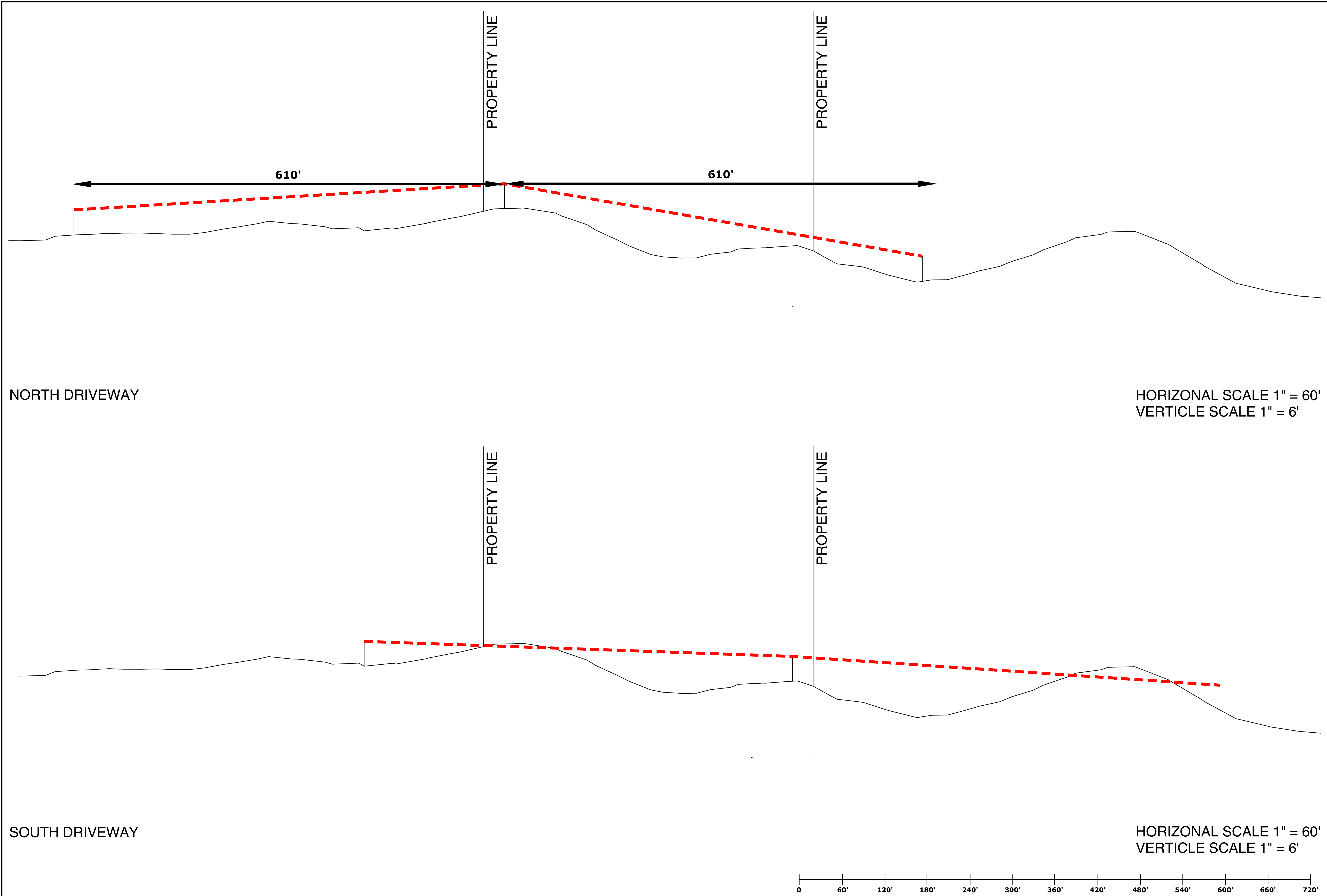

NORTH DRIVEWAY

HORIZONTAL SCALE 1" = 60'
VERTICLE SCALE 1" = 6'

SOUTH DRIVEWAY

HORIZONTAL SCALE 1" = 60'
VERTICLE SCALE 1" = 6'

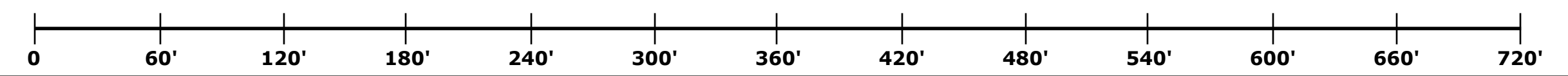

25-0016
PREPARED BY
Plan 4 Land
 Plan 4 Land, LLC, Joe Glass, AICP, Principal
 1 St. Harrison St., P.O. Box 306, Ashley, OH 43003
 (740) 413-4084 | joe@plan4land.net | www.plan4land.net

PROJECT NAME
 Lane Road CAD
CLIENT
 EJ O'Leary
 7735 Lane Road
 Centerburg, OH 43011

SITE INFORMATION
 7735 Lane Road, Centerburg, Ohio 43011
 Parcel No. 516-100-01-164-001 | +/- 9.292 acres
 Porter Township, Delaware County, State of Ohio
PRINTED
 February 24, 2025

Lane Road CAD
RAW TESTS



XX/05